



SMART DETAILS
RINGSCAFF | UNIVERSAL STAIR TOWER



RINGSCAFF

UNIVERSAL STAIR TOWER

DETAILS 03 UNIVERSAL STAIR TOWER | 2024-05-EN

**STRONGER.
TOGETHER.**

 **scafom-rux**

MANAGEMENT



Volker Rux
Managing Director

T +49 2331 47 09-0
info@scafom-rux.de



Marco Hiby
Sales Management

T +49 2331 47 09-200
M +49 151 16 20 65 01
marco.hiby@scafom-rux.de

RENTAL



Stephan Winterhoff
Rental Manager

T +49 2331 47 09-114
M +49 171 56 57 432
stephan.winterhoff@scafom-rux.de



Heiko Ulrich
Rental

T +49 2331 47 09-205
M +49 151 62 50 97 50
heiko.ulrich@scafom-rux.de



Philine Lüling
Rental

T +49 2331 47 09-204
philine.lueling@scafom-rux.de



Tim Bauer
Rental

T +49 2331 47 09-210
tim.bauer@scafom-rux.de



Nadine Prokopp
Rental

T +49 2331 47 09-257
nadine.prokopp@scafom-rux.de

INTERNATIONAL SALES



Deniz Bozkir
Global Account Manager

T +49 2331 47 09-264
M +49 151 15 34 91 40
deniz.bozkir@scafom-rux.de

SALES D / A / CH

SALES DEPARTMENT



Etienne Terlitzki
Sales Manager

T +49 2331 47 09-268
etienne.terlitzki@scafom-rux.de



Udo Lüling
Sales

T +49 2331 47 09-230
udo.lueling@scafom-rux.de



Tim Tempelmann
Sales

T +49 2331 47 09-258
tim.tempelmann@scafom-rux.de



Marina Calamonte
Sales

T +49 2331 47 09-253
marina.calamonte@scafom-rux.de



Sonia Sfragara
Sales

T +49 2331 47 09-251
sonia.sfragara@scafom-rux.de



Alexander Stehnuhl
Sales

T +49 2331 47 09-266
alexander.stehnuhl@scafom-rux.de



Sebastian Wiegand
Sales

T +49 2331 47 09-259
sebastian.wiegand@scafom-rux.de

SALES REPRESENTATIVES



Wulf D. Basse
PLZ: 1/23923-23996

T +49 30 47 03 90 00
M +49 172 21 21 100
wulf.basse@scafom-rux.de



Jörn Winkler
PLZ: 2 (w/o 23923-23996)

T +49 441 68 26 82
M +49 151 16 20 65 04
joern.winkler@scafom-rux.de



Thomas Venn
PLZ: 3/48-49/57-59/586-589

T +49 2331 47 09-245
M +49 151 16 20 41 09
thomas.venn@scafom-rux.de



Sebastian Kurowski
PLZ: 3/48-49/57-59/586-589

T +49 511 45 01 00 00
M +49 170 16 12 446
sebastian.kurowski@scafom-rux.de



Marco Schröder
PLZ: 40-47 Rheinland Süd

T +49 2331 47 09-243
M +49 151 14 77 39 20
marco.schroeder@scafom-rux.de



Maximilian Rux
PLZ: 40-47 Rheinland Nord

M +49 171 29 26 301
maximilian.rux@scafom-rux.de



Daniel Hesbacher
PLZ: 50-56/580-585

T +49 2331 47 09-255
M +49 151 46 16 97 55
daniel.hesbacher@scafom-rux.de



Markus Lock
PLZ: 6/7/88-89 + CH

M +49 160 90 14 28 51
markus.lock@scafom-rux.de



Mirko Langer
PLZ: 80-87/90-97

T +49 8664 32 50 42
M +49 151 14 77 39 22
mirko.langer@scafom-rux.de



Robert Fröhlich
PLZ: 0/98-99

M +49 151 16 20 41 08
robert.froehlich@scafom-rux.de

CONTACT

T +49 2331 47 09-180
WWW.SCAFOM-RUX.DE
SALES@SCAFOM-RUX.DE

Central Depot Hagen
Neue Str. 7
58135 Hagen
T +49 2331 47 09-0

Depot Berlin
Kopenhagener Str. 74a
13407 Berlin-Reinickendorf
T +49 30 47 03 9000

Depot Hamburg
Kulemannstieg 5
22457 Hamburg
T +49 40 54 80 57 48

Depot Hannover
Entenfangweg 9
30419 Hannover
T +49 511 450 100 00

Depot Leipzig
An der Bahn 11
04319 Leipzig-Engelsdorf
T +49 341 251 38 05

Depot Munich
Krautgartenstr. 36
85241 Hebertshausen
T +49 8131 702 9999

Depot Switzerland
Kantonsstrasse 131
CH-6048 Horw
T +41 41 244 0770

RINGSCAFF

UNIVERSAL STAIR TOWER

02-03 | CONTACT PERSONS | CONTENTS

04-07 | SYSTEM OVERVIEW

08-09 | VARIANTS

PRICE LIST

10-22 | PRODUCTS

- 10 | STAIR STRINGERS
- 10-11 | STEP ACCESSORIES
- 11-12 | RAILING (WEDGE CONNECTION)
- 12-13 | HANDRAILS
- 14 | DECKS
- 15 | ACCESS HATCHES
- 16-17 | RAILING (COUPLING CONNECTION)
- 18 | COVER PANELS
- 19 | STAIR CONSOLES
- 20 | CONSTRUCTION DOORS
- 20-21 | ACCESSORIES AND LOGISTICS
- 21-23 | PERSONAL PROTECTION

24-26 | CONSTRUCTION VARIANTS

27-29 | APPROVALS

30-31 | SCAFOM-RUX-SERVICE | APP | ANIMATIONS

32-33 | PRODUCT OVERVIEW

34-35 | RENTAL

GOOD TO KNOW

SIMPLY ASSEMBLED - STABLE IN EVERY RESPECT

RINGSCAFF is an extremely stable modular scaffolding with top ratings in terms of connection values.

Yet logistics and the simple assembly principle are features that need to be particularly highlighted.

The simple steps are always the same:

- Position the ledger or diagonal
- Insert wedge
- The hammer blow makes a load-bearing connection out of a form-fit one

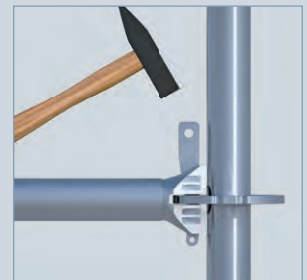

As many as 4 ledgers and 4 diagonals can be fitted to a single ring at any one time.

This means that a compact yet quite slender scaffold node results from a simple ring; a connection that can withstand the very highest loads.

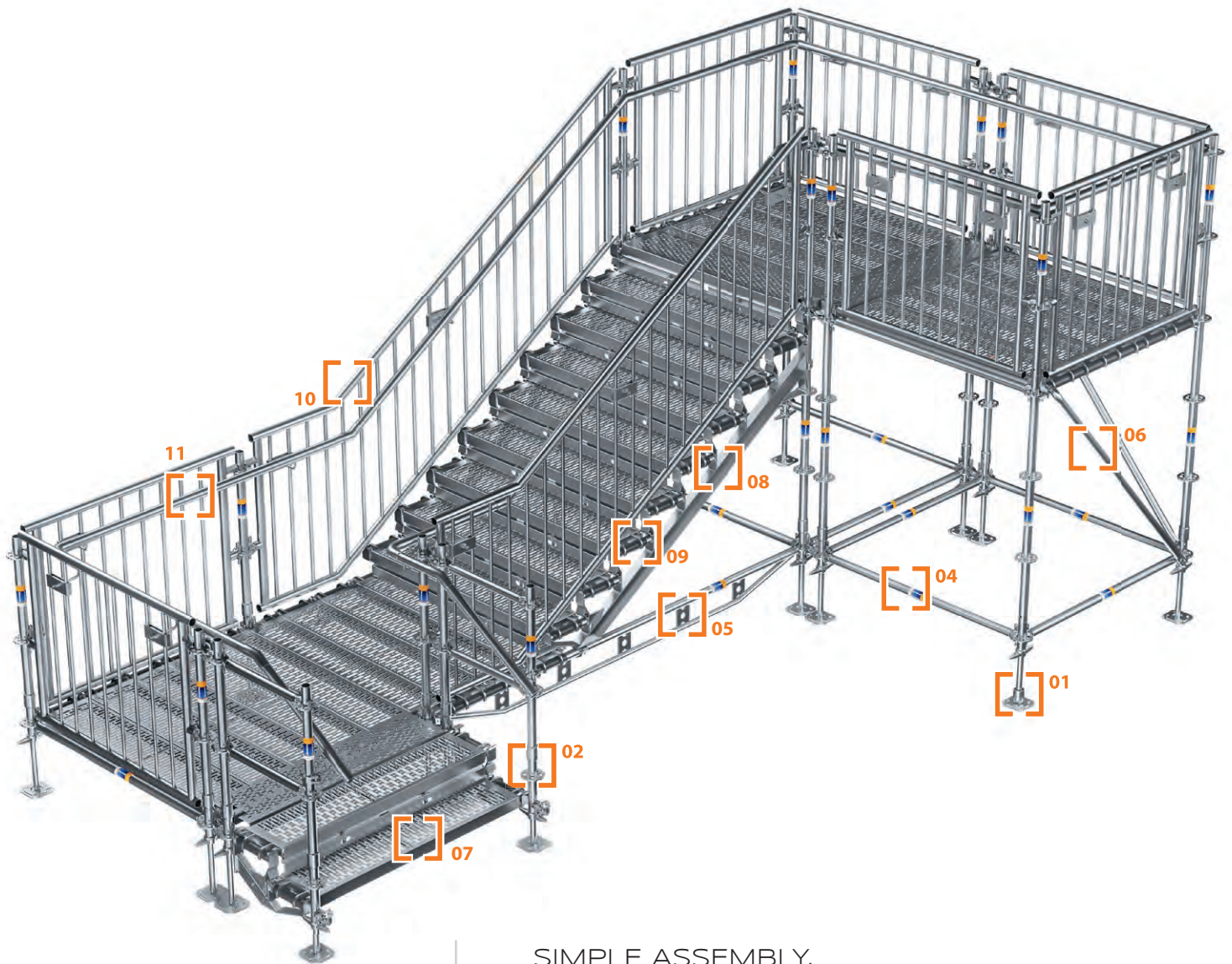

SIMPLE ASSEMBLY, OPTIMUM SAFETY.

- | | | |
|-------------------------|-------------------|-----------------------------|
| 01 Base jack | 05 Double ledger | 09 Footfall sound absorber |
| 02 Lead-off adapter | 06 Diagonal | 10 Wedge connection railing |
| 03 Standards with rings | 07 Deck | 11 Inner handrail |
| 04 Horizontal ledger | 08 Stair stringer | |



The RINGSCAFF system makes do with just a few basic elements. However, thanks to the wide product range available it can be extended to such a degree that there is hardly any challenge in modular scaffolding that cannot be solved with it. You can see the many supplementary parts in our animations under vimeo.com/ruxgmbh/albums.



*Well considered:
Together with the SCAFFGUARD cladding system,
a "panic-door solution" can be readily installed,
allowing an escape outdoors
but not one that enables access indoors.*

PERFECT FOR CUSTOMISED UND VOLUMINOUS SCAFFOLDS, TRENDSETTING IN DESIGN AND FUNCTION

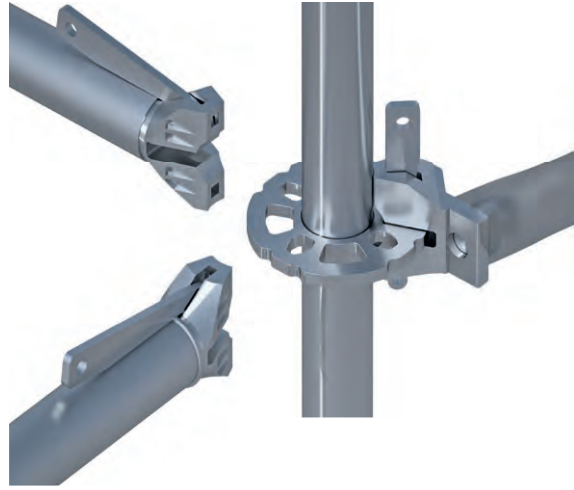
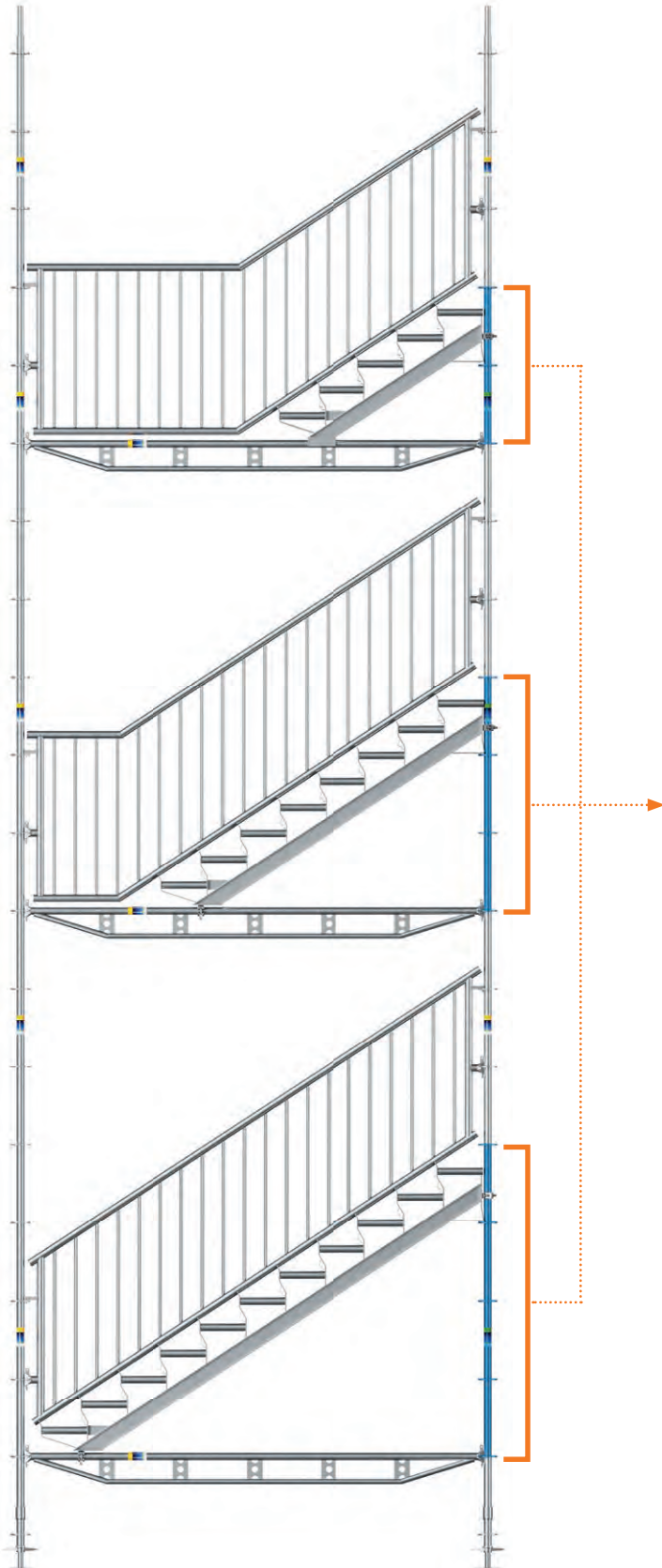

Up to 8 wedge heads can be attached to a standard ring in the RINGSCAFF system. That is sufficient for a large number of ledgers and diagonals to be fitted with their heads at a 45-degree angle to one another. Even other angles are feasible given the predefined holing in the rings or by using supplementary components (e.g. flex decks – see next page). You can't get much more versatile than that!

UNIVERSAL STAIR STRINGER FLEXIBEL IN HEIGHT

The height gradation of 0.50 / 1.00 / 1.50 or 2.00 metres is freely selectable on each floor and facilitates property-specific adaptation for entrances at different heights. This means that the staircase height can always be adapted to the circumstances. Subsequent changes to the scaffolding are also possible.

Flexible:
The base plate remains free when installing the stair stringer and is therefore available for important connections such as ledgers and diagonals.

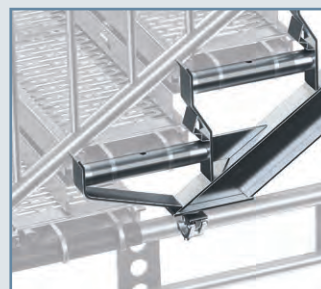

Customised:
The lower support of the stair stringer is placed directly on the transom. This means that the same ledger can be used for all stringer heights. The stair treads are formed by tube supports in the desired stair width.

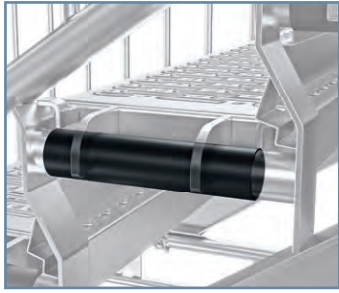

FOOTFALL SOUND ABSORBER

Reduces the majority of movement noise caused by users. A simple solution with a big impact!

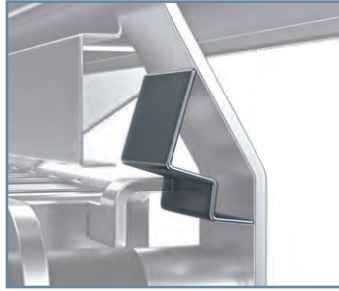

DECK LOCKING

By changing the geometry, the deck locking is now integrated into the system.

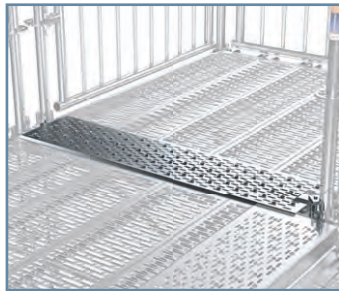

CLEVER LEDGERS

Gaps are covered by clever ledger connections - screw-free! And this applies to both the steps and the platforms of the towers. There are no tripping hazards.



WEDGE CONNECTION RAILING

Even the largest railing types can be installed by one person by simply hooking them in. One hammer blow and the RINGSCAFF wedge connection is in place.



INNER HANDRAILS

Added comfort: handrails for adults and children included. Plus in safety: Standardised balustrades are designed for child safety.

VARIABLE STAIRCASE
WIDTH THROUGH
USE OF SYSTEM DECKS

VARIABLE EXIT HEIGHTS
THROUGH VARIOUS UNI-
VERSAL STAIRS

HIGH PROPORTION
OF STOCK MATERIAL,
FEW NEW PARTS

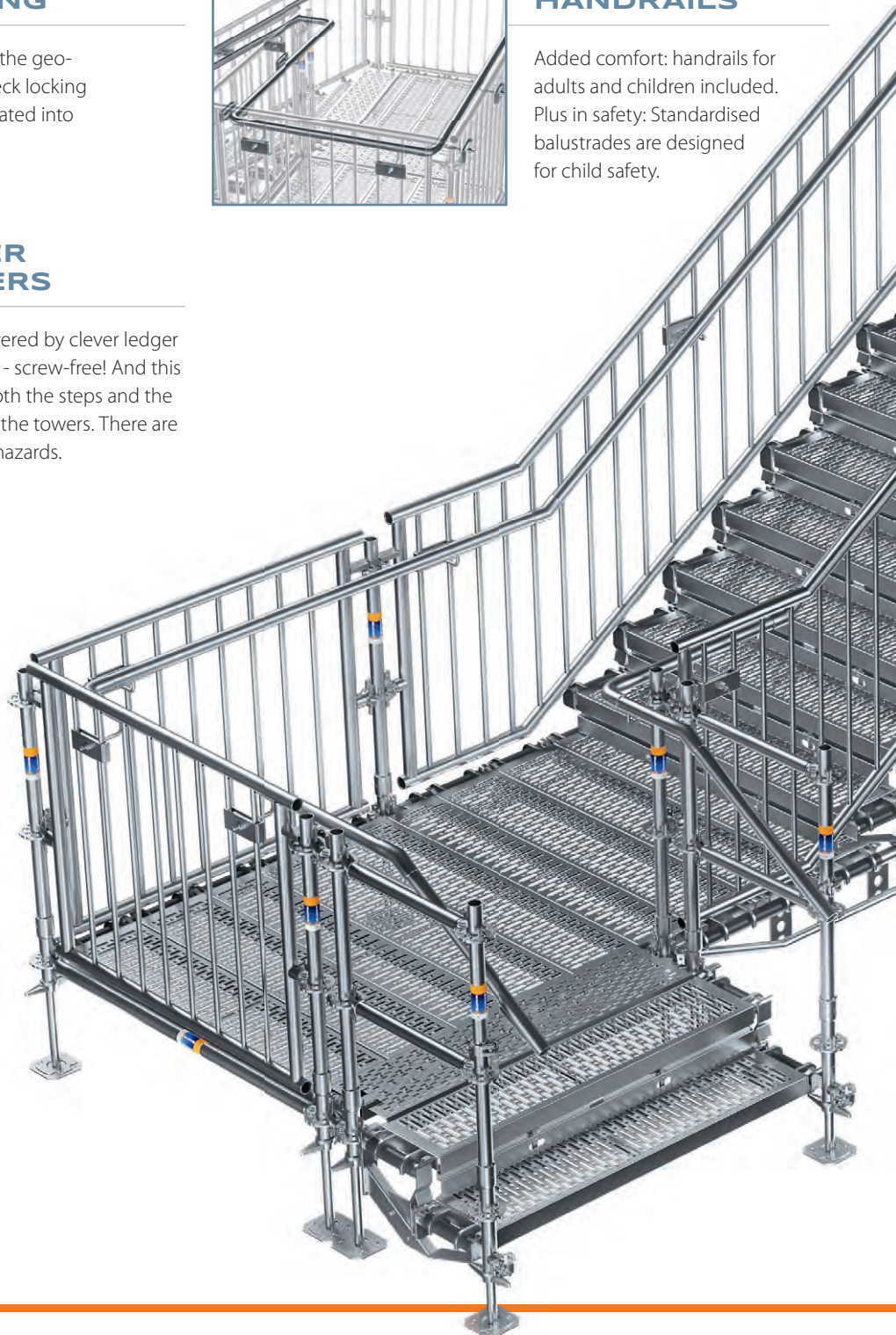

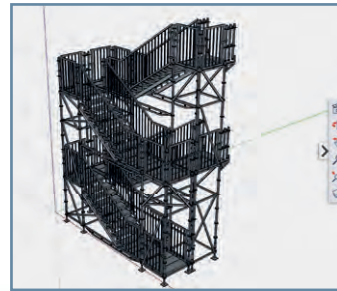
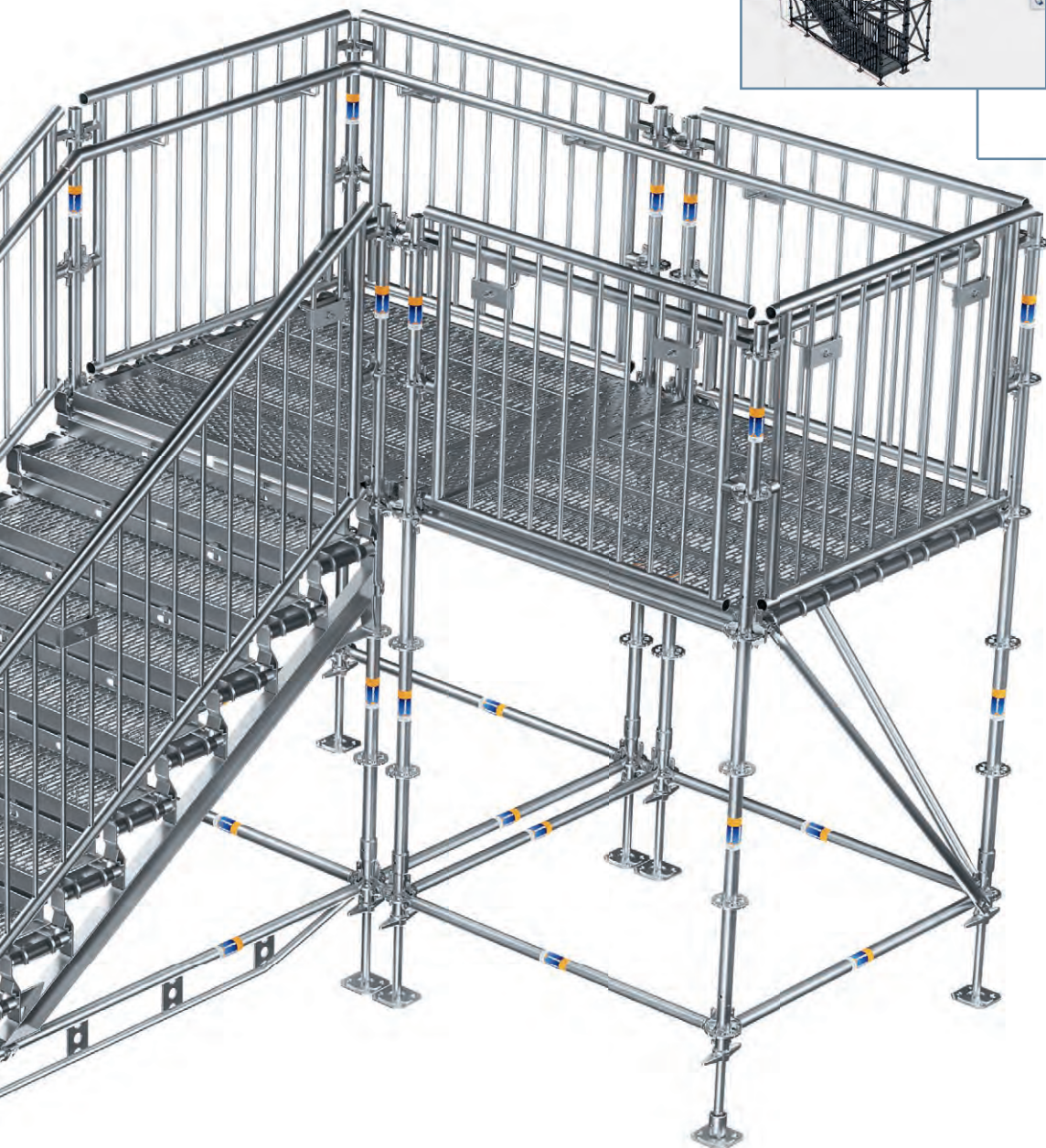

INDIVIDUAL CALCULATION

We will calculate your customised stair tower and provide you with an assembly drawing in 2D and interactive 3D. Example drawing in the QR code.



ACCESS FROM PLUG-IN STEPS

The new, adaptable staircase access is another detail for greater user comfort and safety and can also be used extremely flexibly.



EVEN SAFER WITH RISERS

The optional covering of the vertical spaces between the steps increases safety when used as an escape route.

SMALL, MEDIUM, TALL? BUT ALWAYS READY TO GO!

VARIOUS JOBS, VARIOUS TYPES OF STAIRS

Changing levels in a scaffolding can be done with varying degrees of convenience. The ladder frame is quite adequate for a number of jobs – but the real professional will offer customers bespoke alternatives. Here we are presenting just three of them.

SUSTAINABLE DESIGN

The aluminium stairway can be quickly converted to fit for SUPER façade scaffolding by simply changing the head section and the inner and outer handrails can be readily fitted anyway in either scaffolding system.

When a site stairway is required, no additional special component parts are needed for the stair tower – the rest is simply built out of standard RINGSCAFF components: standards, ledgers and diagonals.

The universal stair stringer can be used for various stair widths; with the stairs being assembled with normal steel decks. This is economic multiple usage that enables lean stock management. Details can be found in our Stair Tower price list.

FULL SYSTEM INTEGRATION

PRACTICAL MULTIPLE USES

MATERIAL, WORK AND TIME SAVINGS





Whether it is a slim aluminium stairway, an extra-wide ascent for equipping the scaffolding or an approved emergency stairway tower – all the conventional options for changing levels can be implemented with RINGSCAFF ... and, of course, the "good old" ladder frame is still available as well.



PLAN YOUR ASCENT OPTIONS

ALUMINIUM PLATFORM STAIRWAY

- Slim stairway solution with a width of 60 cm
- Can also be used with SUPER façade scaffolding thanks to the exchangeable head section

STEEL SITE STAIRWAY

- Extremely economic
- Only special component in the scaffolding: the stairway itself
- Otherwise, only standard parts fitted
- Handrails out of diagonals

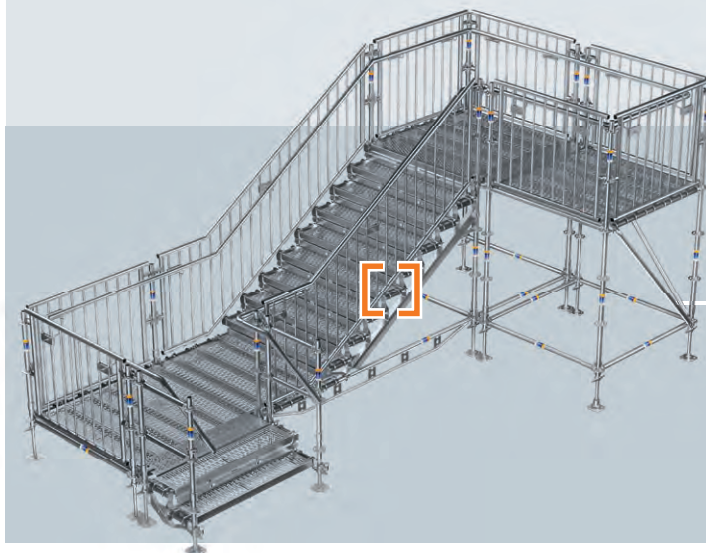

UNIVERSAL STAIR STRINGER

- Variable ascent width since system decks are used as steps
- Special handrails allow it to be used by the public as an emergency stairway tower
- Entire bridging sections can be implemented

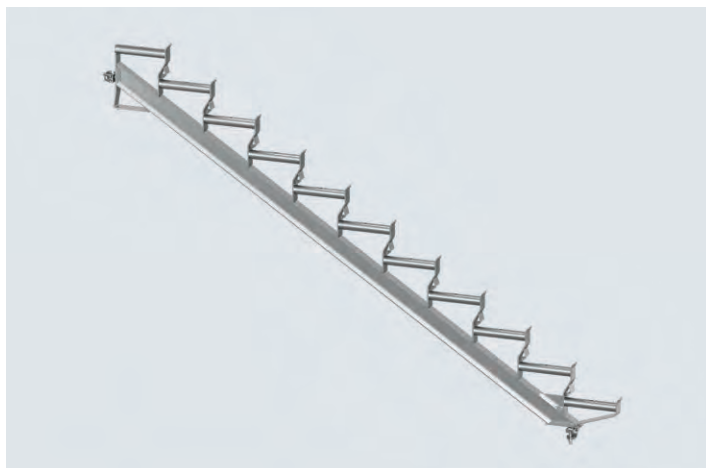

Universal stair stringer

Modified product geometry incl. integrated step safety device. For the construction of generously dimensioned stair structures as escape, replacement or makeshift stairs, temporary stair towers or for the convenient scaffold access with tools and materials. Stair covering made of steel planks for tube hook-up with a width of 0.29 m. Stair inclination corresponds to scaffold bays with 3.00/3.07 m length.

Info	H/L x B (m)	kg	Pack	Part No.	€/each
2 steps, AF 19	3.00 x 0.50	9.30	20	E04RS1688	139.00
2 steps, AF 22	3.00 x 0.50	9.30	20	E04RS1687	139.00
5 steps, AF 19	3.00 x 1.00	22.50	20	E04RS1690	255.50
5 steps, AF 22	3.00 x 1.00	22.50	20	E04RS1689	255.50
8 steps, AF 19	3.00 x 1.50	36.50	20	E04RS1692	398.00
8 steps, AF 22	3.00 x 1.50	36.50	20	E04RS1691	398.00
11 steps, AF 19	3.00 x 2.00	48.40	20	E04RS1694	495.50
11 steps, AF 22	3.00 x 2.00	48.40	20	E04RS1693	495.50

Please state AF



Universal acoustic pad

Reduces noise to a minimum when using the stairs. The acoustic tubes are pushed over the support tubes through a longitudinal gap.

Info	H/L x B (m)	kg	Pack	Part No.	€/each
	0.28		20	07938	①
	0.84		20	07935	①
	1.00		20	07937	①
	1.34		20	07934	①
	1.76		20	07936	①
	2.00		20	07933	①

Price on request



Universal anti-lift retainer KV

Lift-off protection for the top step covering of the universal stair stringer. Is fixed to the ring above the stringer with a wedge.

Info	H/L x B (m)	kg	Pack	Part No.	€/each
For top stair	0.16 x 0.06	1.03	20	E04RS1695	19.80

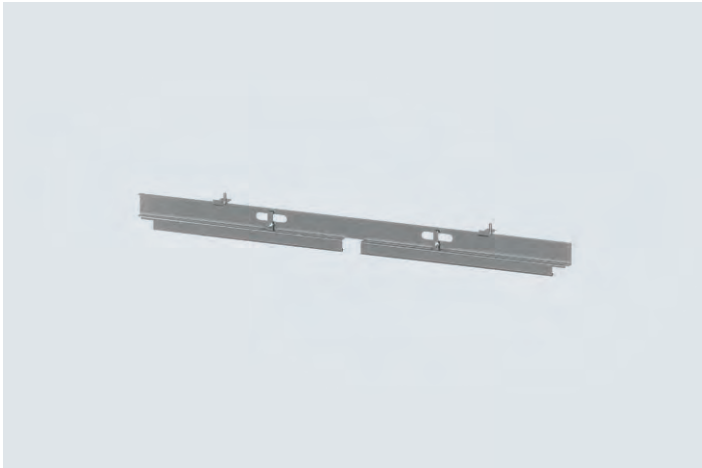
**Universal riser**

Closing of the space between 2 steps. Falling of objects or slipping into the space between is prevented.

Info	H/L x B (m)	kg	Pack	Part No.	€/each
For 1.50 m width	1.39	3.18	20	E04RS1704	55.00

**Universal guardrail KV, straight**

Railing type: straight.

Bays: 1.00 m / 1.50 m / 2.00 m.

Installation height: 1.10 m.

Spacing of filling bars: 135 mm.

Assembly using wedge connections. The system-independent solution for use in construction and emergency stairway towers in conjunction with universal stair stringers.

Info	H/L x B (m)	kg	Pack	Part No.	€/each
	1.10 x 1.00	19.20	10	E04RS1733	218.00
	1.10 x 1.50	25.70	10	E04RS1686	269.50
	1.10 x 2.00	32.80	10	E04RS1734	271.90

**Universal guardrail KV 2.00 m x 3.00 m, inclined**

Railing type: inclined, long.

Exit height: 2.00 m / 11 steps.

Installation height: 1.10 m.

Spacing of filling bars: 135 mm.

Assembly using wedge connections.

Info	H/L x B (m)	kg	Pack	Part No.	€/each
	3.00 x 2.00	55.70	10	E04RS1682	379.60

**Universal guardrail KV 1.50 m x 3.00 m, end kink, inclined**

Railing type: inclined with end kink.

Exit height: 1.50 m / 8 steps.

Installation height: 1.10 m.

Spacing of filling bars: 135 mm.

Assembly using wedge connections

Info	H/L x B (m)	kg	Pack	Part No.	€/each
	1.50 x 3.00	55.10	10	E04RS1683	372.50



Universal guardrail KV 1.00 m x 3.00 m, middle kink, inclined

Railing type: inclined, short.

Exit height: 1.00 m / 5 steps.

Installation height: 1.10 m.

Spacing of filling bars: 135 mm.

Assembly using wedge connections.

Info	H/L x B (m)	kg	Pack	Part No.	€/each
	1.00 x 3.00	53.90	10	E04RS1684	375.00



Universal guardrail KV 1.00 m x 1.50 m, inclined

Railing type: inclined, short. Exit height: 1.00 m / 5 steps. Installation height:

1.10 m. Spacing of filling bars: 135 mm. Assembly using wedge connections.

Info	H/L x B (m)	kg	Pack	Part No.	€/each
	1.00 x 1.50	29.80	10	E04RS1743	265.00



Universal guardrail KV 1.50 m, inclined

Railing type: inclined with end kink.

Exit height: 1.50 m / 2 steps.

Installation height: 1.10 m.

Spacing of filling bars: 135 mm.

Assembly using wedge connections.

Info	H/L x B (m)	kg	Pack	Part No.	€/each
	0.50 x 1.50	29.91	10	E04RS1685	295.00



Safety handrail

Childproof handrail made of aluminium tube.

Diameter: 42 mm.

Wall thickness: 2 mm.

Info	H/L x B (m)	kg	Pack	Part No.	€/each
	6.00		25	07931	52.20 ①

**Safety handrail, holder**

Holder for safety handrail. Is fixed between the vertical guardrail struts of the universal guardrail.

Info	H/L x B (m)	kg	Pack	Part No.	€/each
	0.17 x 0.16	0.76	50	E04AA1070	39.50

**Safety handrail, holder with semi-coupler**

Holder for safety handrail. Mounted on standards of the stair tower with semi-couplers.

Info	H/L x B (m)	kg	Pack	Part No.	€/each
	0.15 x 0.98	0.90	50	E04AA1068	34.80

**Joints for safety handrail**

Plastic material. Connects 2 safety guardrails for corner solutions. The angle of the joint can be flexibly adjusted.

Info	H/L x B (m)	kg	Pack	Part No.	€/each
Anthracite			50	07930	

Price on request

①

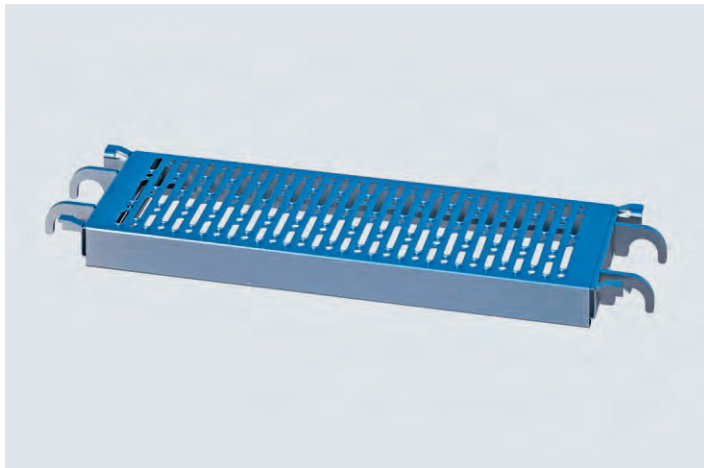

Steel deck 0.29 m for tube hook-up – RX metric

Comes with tube hook-up for modular ledgers or system-independent scaffold tubes. The indestructible scaffold deck. Resistant to even the very highest physical demands, weather influences and chemical substances. The perforated surface only allows a minimum amount of building and blasting material to collect. Optimal stackability. Comes with integrated deck retainer to secure against lift.

Info	H/L x B (m)	kg	Pack	Part No.	€/each
LC6	0.67 x 0.29	5.70	52	01677	58.00
LC6	1.00 x 0.29	8.40	52	01693	64.30
LC6	1.50 x 0.29	11.80	52	01694	72.70
LC6	2.00 x 0.29	15.80	52	01695	84.20
LC5	2.50 x 0.29	18.80	52	01696	99.70
LC4	3.00 x 0.29	22.00	52	01697	109.00

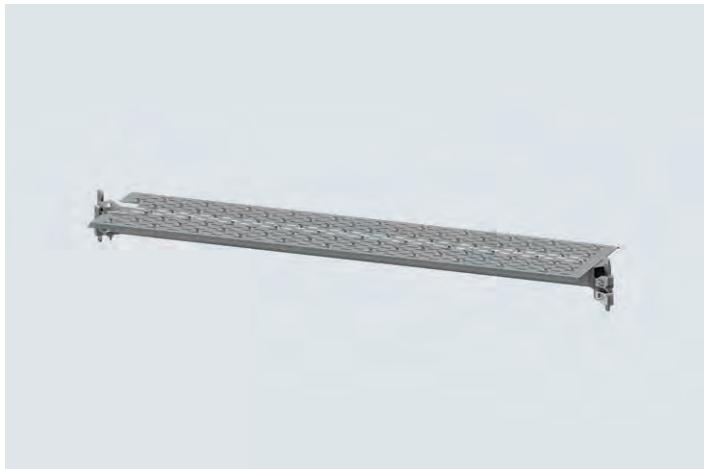

Universal gap ledger

Closes the gap between platforms on the universal stair tower. Assembly via 2 wedge connections. Additional covering plates are no longer necessary.

Info	H/L x B (m)	kg	Pack	Part No.	€/each
	1.00 x 0.32	7.90	10	E04RS1721	99.90
	1.50 x 0.32	11.50	10	E04RS1708	126.50
	2.00 x 0.32	15.20	10	E04RS1722	159.50



Universal access step

Convenient access to landings or as the first step of the universal stair tower. There is no need for ledgers or covering plates. Installation height: 70 mm.

Info	H/L x B (m)	kg	Pack	Part No.	€/each
	1.00 x 0.23	7.40	10	E04RS1723	83.50
	1.50 x 0.23	10.20	10	E04RS1707	94.00
	2.00 x 0.23	13.10	10	E04RS1724	133.50

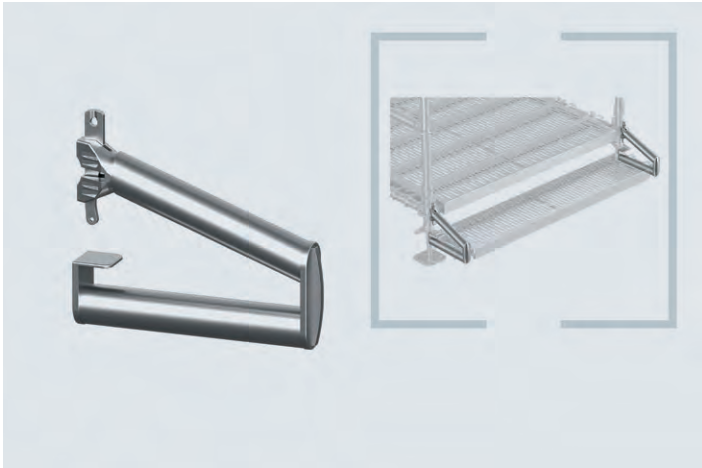
**Stair access bracket**

Ideal access to the universal stair tower when using standard system decks.

Info	H/L x B (m)	kg	Pack	Part No.	€/each
	0.29 x 0.24	3.38	10	E04RS1728	①

Price on request

**Insertion stair starter section**

Starting piece of the 3-part insertion stair. Semi-coupler to accommodate guardrails. Please indicate spanner width.

Info	H/L x B (m)	kg	Pack	Part No.	€/each
	0.65 x 0.27	5.00	10	E04RS1699	99.70

**Insertion stair middle section**

Centre piece of the 3-part insertion stair. The rails are connected by insertion.

Info	H/L x B (m)	kg	Pack	Part No.	€/each
	0.47 x 0.29	5.00	10	E04RS1697	72.50

**Insertion stair end section**

The end piece of the 3-part insertion stair is mounted on the ring of the platform, the stair tower or the scaffolding by means of a wedge connection.

Info	H/L x B (m)	kg	Pack	Part No.	€/each
	0.35 x 0.29	4.70	10	E04RS1696	72.50

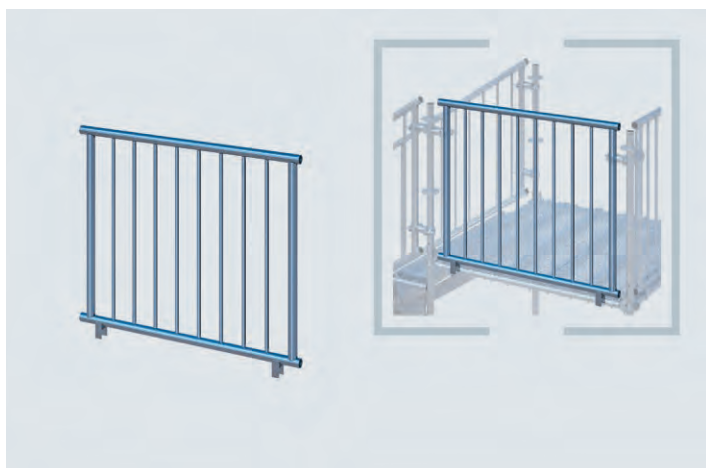

Handrail for universal stair stringer, straight

Handrail type: straight

Bays: 1.00 m / 1.50 m / 2.00 m

(07 dimension / 09 dimension)

Installation height: 1.10 m

Distance between the filling struts: 135 mm

Handrail holders required: 2 pieces

The system-independent solution for use in site and emergency exit stairways together with the universal stair stringer. Fitting is implemented with vandalism-secure screw connections and handrail holders as well as with metric handrail holders with tele-function for non-metric applications (07 and 09 dimensions).

Info	H/L x B (m)	kg	Pack	Part No.	€/each
	1.10 x 1.00	18.00	10	01923	144.40 ②
	1.10 x 1.50	25.00	10	01924	169.00 ②
	1.10 x 2.00	30.00	10	01938	239.00

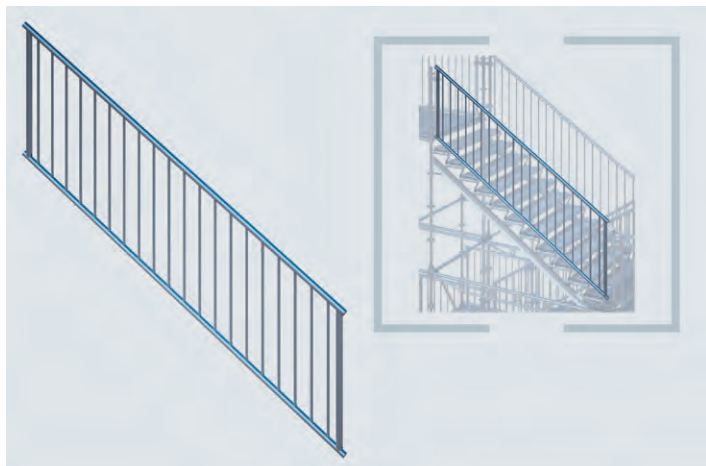

Handrail for universal stair stringer, 2.00 m x 3.00 m., inclined

Handrail type: inclined, long

Exit height: 2.00 m / 11 steps

Installation height: 1.10 m

Distance between the filling struts: 135 mm

Handrail holders required: 4 pieces

The system-independent solution for use in site and emergency exit stairways together with the universal stair stringer. Fitting is implemented with vandalism-secure screw connections and handrail holders as well as with metric handrail holders with tele-function for non-metric applications (07 and 09 dimensions).

Info	H/L x B (m)	kg	Pack	Part No.	€/each
	2.00 x 3.00	40.00	10	01925	399.00 ②



Handrail for universal stair stringer, 1.00 m x 3.00 m., inclined, angled

Handrail type: inclined with middle kink (buckled)

Exit height: 1.00 m / 5 steps

Installation height: 1.10 m

Distance between the filling struts: 135 mm

Handrail holders required: 4 pieces

The system-independent solution for use in site and emergency exit stairways together with the universal stair stringer. Fitting is implemented with vandalism-secure screw connections and handrail holders as well as with metric handrail holders with tele-function for non-metric applications (07 and 09 dimensions).

Info	H/L x B (m)	kg	Pack	Part No.	€/each
	1.00 x 3.00	48.00	10	01922	358.00 ②



Handrail for universal stair stringer, 1.50 m x 3.00 m., inclined, angled

Handrail type: inclined with end kink (buckled)

Exit height: 1.50 m / 8 steps

Installation height: 1.10 m

Distance between the filling struts: 135 mm

Handrail holders required: 4 pieces

The system-independent solution for use in site and emergency exit stairways together with the universal stair stringer. Fitting is implemented with vandalism-secure screw connections and handrail holders as well as with metric handrail holders with tele-function for non-metric applications (07 and 09 dimensions).

Info	H/L x B (m)	kg	Pack	Part No.	€/each
	1.50 x 3.00	48.00	10	01933	366.00 ②

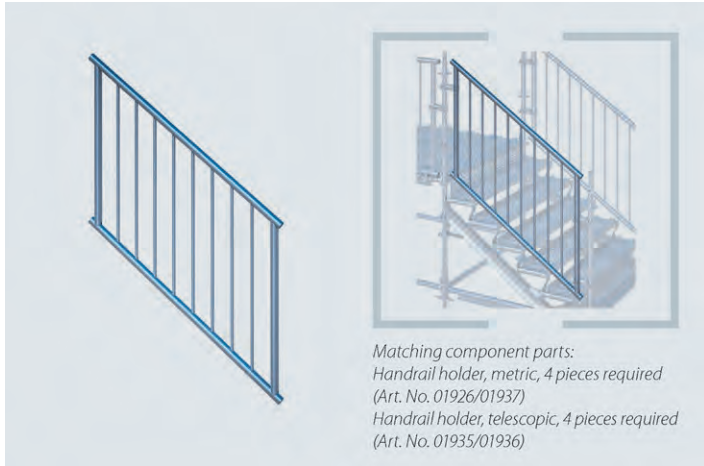
**Handrail for universal stair stringer, 1.00 m x 1.50 m., inclined**

Handrail type: inclined, short

Exit height: 1.00 m / 5 steps

Installation height: 1.10 m

Distance between the filling struts: 135 mm

Handrail holders required: 4 pieces

The system-independent solution for use in site and emergency exit stairways together with the universal stair stringer. Fitting is implemented with vandalism-secure screw connections and handrail holders as well as with metric handrail holders with tele-function for non-metric applications (07 and 09 dimensions).

Info	H/L x B (m)	kg	Pack	Part No.	€/each
	1.00 x 1.50	25.00	10	01934	157.00 ②

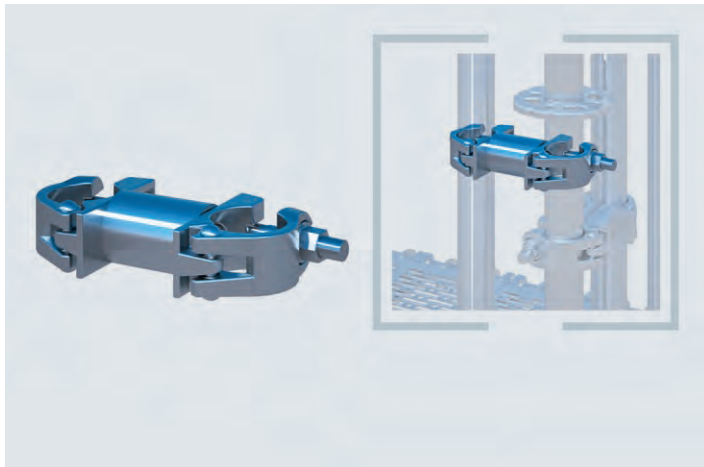
**Handrail holder, metric**

Suitable for metric scaffold bays.

Tightening torque of the collar nuts 50 Nm. Version corresponds to EN 74. Axial dimension: 128 mm.

Info	H/L x B (m)	kg	Pack	Part No.	€/each
RX / AF 19	0.13	1.60	20	01926	19.80 ②
RX / AF 22	0.13	1.60	20	01937	19.80 ②

metric

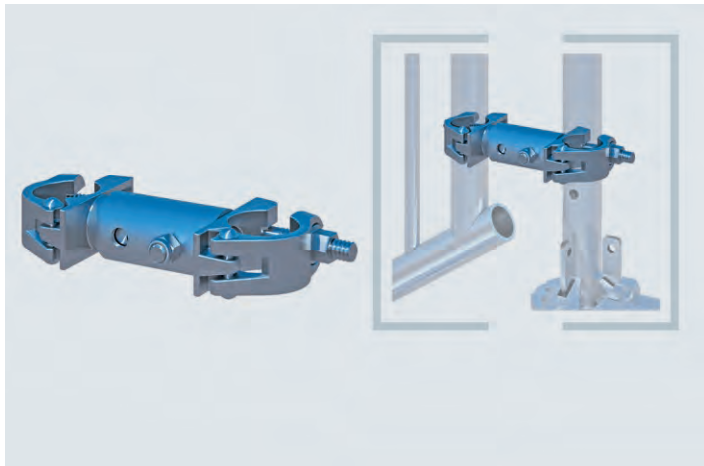
**Handrail holder, tele**

Suitable for 07/09 scaffold bay dimensions.

Tightening torque of the collar nuts 50 Nm. Version corresponds to EN 74. Axial dimension 163 mm to 203 mm.

Info	H/L x B (m)	kg	Pack	Part No.	€/each
PC,LA / AF 19	0.16	2.13	20	01935	19.80 ②
PC,LA / AF 22	0.16	2.13	20	01936	19.80 ②

07 dimension

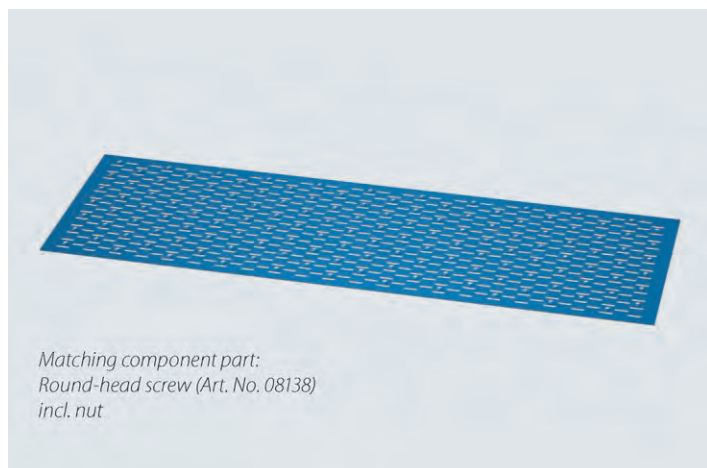

Cover plate, flat

To cover gaps. Plate thickness 2 mm.

Info	H/L x B (m)	kg	Pack	Part No.	€/each
	0.85 x 0.45	4.90	1	08134	45.00 ②
	1.35 x 0.45	7.90	1	08132	73.20 ②

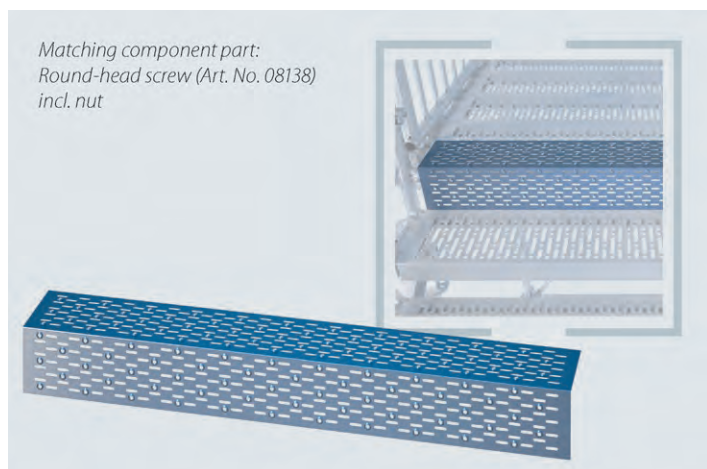

Cover plate, angled

To cover the steps. Plate thickness 2 mm.

Info	H/L x B (m)	kg	Pack	Part No.	€/each
	0.88 x 0.36	4.40	1	08135	39.00 ②
	1.38 x 0.36	6.80	1	08130	97.00 ②



Round-head screw

M6 x 25, DIN 603-MU-4.6, for the covering plate incl. large-diameter washer 6.4 x 25 and nut.

Info	H/L x B (m)	kg	Pack	Part No.	€/each
	0.02 x 0.01	0.02	200	08138	0.39 ②

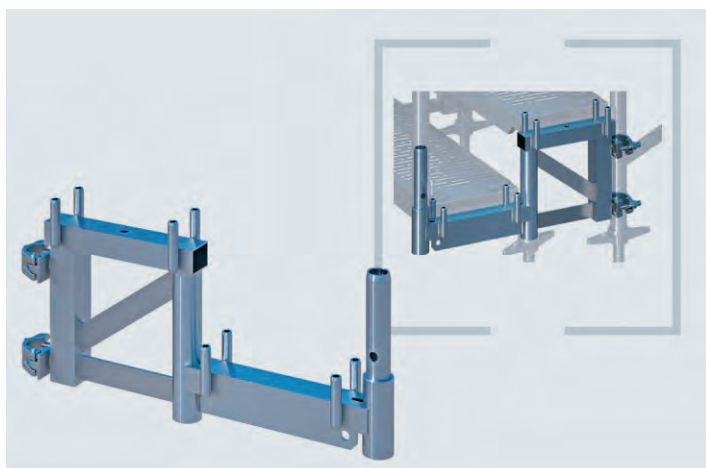

Stair bracket lead-off adapter for system decks

For the DIN-conform fitting of temporary stairs, in particular for intermediate heights and to enable access to the scaffold.

The scaffold stairs are flexible in height and width. Stair widths of 0.65 m to 3.00 m can be constructed with the use of SUPER system decks. The extension steps are implemented with stair brackets. 2 lead-off adapters as well as 2 base jacks are required for each stairway. SUPER system decks are secured against lift by locking springs (Art. No. 04552).

Info	H/L x B (m)	kg	Pack	Part No.	€/each
AF 19	0.68 x 0.32	8.00	10	01941_19	114.00 ②
AF 22	0.68 x 0.32	8.00	10	01941_22	114.00 ②

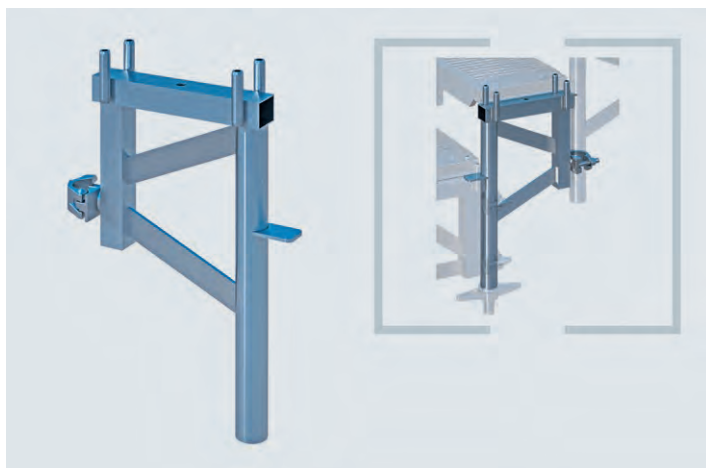

Stair bracket for system decks

Extension steps for the scaffold stairway are created with stair brackets for SUPER system decks. They are positioned on the lead-off adapters for the first extension step and they can be flexibly supplemented in height and width.

Guardrails can be fitted using either tubes or diagonals. 2 stair brackets are needed for each extension step. SUPER system decks are secured against lift by locking springs (Art. No. 04552).

Info	H/L x B (m)	kg	Pack	Part No.	€/each
AF 19	0.30 x 0.48	5.00	50	01942_19	66.00 ②
AF 22	0.30 x 0.48	5.00	50	01942_22	66.00 ②

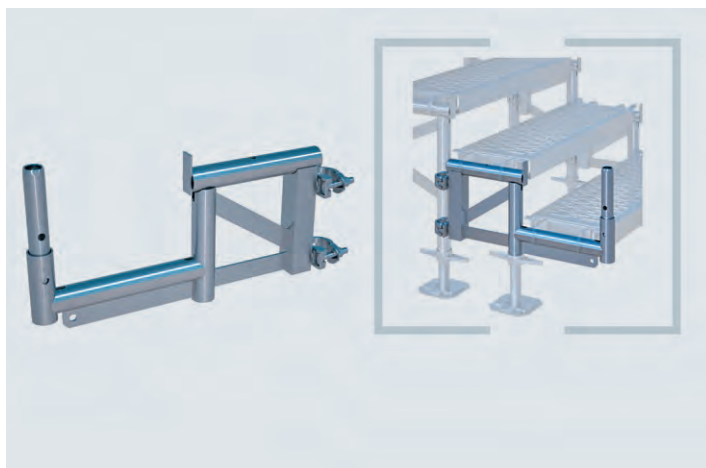

Stair bracket lead-off adapter for tube hook-up

For the DIN-conform fitting of temporary stairs, in particular for intermediate heights and to enable access to the scaffold.

The scaffold stairs are flexible in height and width. Various stair widths of up to 3.07 m can be constructed with the use of decks (system-independent) for tube hook-up. The extension steps are implemented with stair brackets for tube hook-up. 2 lead-off adapters as well as 2 base jacks 0.30 m are required for each stairway. The decks are secured against lift by retainers integrated into the decks.

Info	H/L x B (m)	kg	Pack	Part No.	€/each
AF 19	0.68 x 0.32	7.70	10	01943_19	85.30 ②
AF 22	0.68 x 0.32	7.70	10	01943_22	85.30 ②

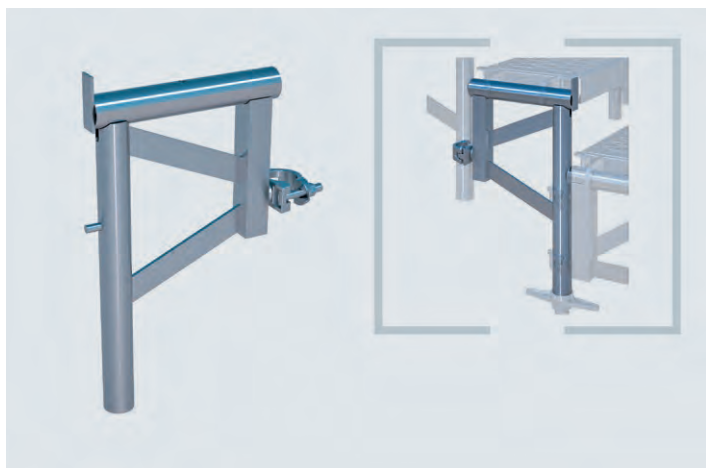

Stair bracket for tube hook-up

Extension steps for the scaffold stairway are created with stair brackets for decks with tube hook-up. They are positioned on the lead-off adapters for the first extension step and they can be flexibly supplemented in height and width (system-independent). Handrails can be fitted using either tubes or diagonals. 2 stair brackets are needed for each extension step. Step height approx. 160 mm to 190 mm. The decks are secured against lift by retainers integrated into the decks.

Info	H/L x B (m)	kg	Pack	Part No.	€/each
AF 19	0.30 x 0.48	4.90	50	01944_19	69.00 ②
AF 22	0.30 x 0.48	4.90	50	01944_22	69.00 ②



Scaffguard construction door 1.25 m

Scaffguard construction door incl. jamb frame and safety lock and key: coated. Access in the frame of a Scaffguard installation.

Info	H/L x B (m)	kg	Pack	Part No.	€/each
	2.00 x 1.25	63.00		07215	780.00

Price on request

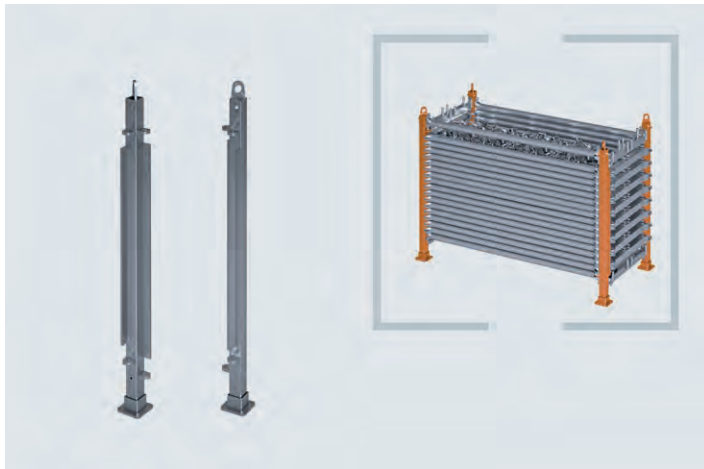

Modular pallet

Flexible pallet. Assembly according to one's own requirements, e.g. from own stock. Assembly of boxes for small parts is possible. Use of 2 left and 2 right posts. Stackable.

Info	H/L x B (m)	kg	Pack	Part No.	€/each
Left post	1.22 x 0.10	9.40	2	07416	95.00
Right post	1.22 x 0.10	9.40	2	07417	95.00

NEW

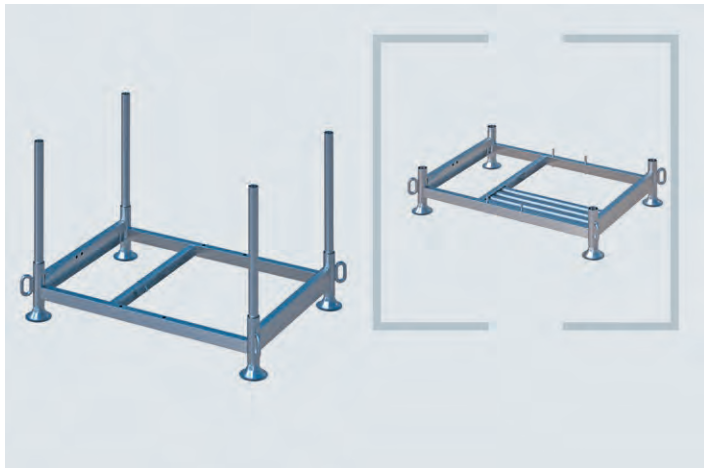

Duralok stacking rack, collapsible

Simple principle – numerous uses. Space-saving when not in use as it is collapsible. Consists of a base frame and four insertion tubes (diameter 48.3 mm). The insertion tubes can be substituted by longer ones when need be. Designed for fork-lift loading and crane transport. Stackable thanks to the large circular feet that also prevent any sinking into soft ground and offer protection for the contact surface. Payload 1,500 kg; with 4 crane lugs.

Rollers 10 kN (Art. No. 05507) can be used to make the rack manoeuvrable.

Duralok side sections (Art. No. E08SR0035) for small parts available as an option.

H/L x B (m)	kg	Pack	Part No.	for order volume of: €/each	
1.25 x 0.85	45.60	20	E08SR0032	1: 240.00	10: 149.50 50: 139.50

SNP

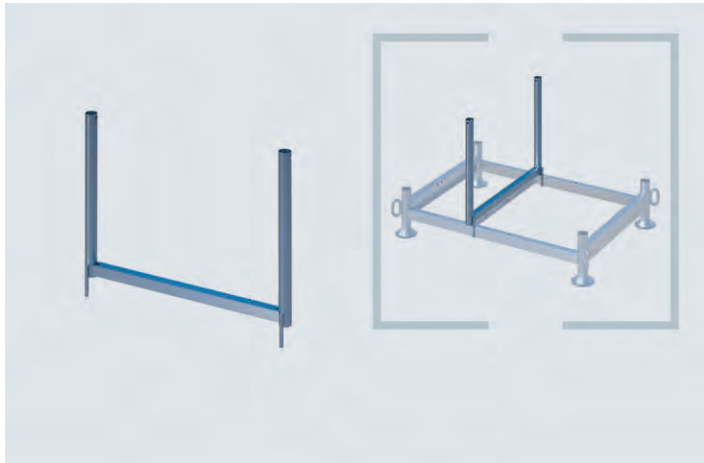

Central insertion frame

An intermediate element for the Duralok stacking rack for the storage and secure transport of short scaffold parts.

H/L x B (m)	kg	Pack	Part No.	for order volume of: €/each	
0.85	7.00	1	E08SR0034	1: 28.00	5: 23.80 10: 21.40 ①

SNP

**Euro-Pool DB mesh box pallet**

Europe-wide exchangeable standard mesh box with wooden floor (EPAL guidelines). 2 side flaps for individual removal. Colour: grey.

H/L x B (m)	kg	Pack	Part No.	for order volume of: €/each		
1.24 x 0.84	70.00	1	04856	1: 248.00	5: 189.00	10: 175.00 ②

**Underlay pad for base jack**

Fitted with reflectors, out of plastic material.

B: 0.265 m x L: 0.235 m x H: 0.01 m

Info	kg	Pack	Part No.	for order volume of: €/each		
	0.20	80	05632	1: 3.40	10: 2.45	50: 2.10

SNP

**Protective cap for standard rings**

Comes with opening for ledgers.

Info	kg	Pack	Part No.	for order volume of: €/each		
	0.06	30	05631	1: 3.40	10: 2.45	50: 1.90

SNP

**Protective cap for standard rings, complete**

Set consists of 2 caps.

Info	kg	Pack	Part No.	for order volume of: €/each		
	0.09	30	05630	1: 3.40	10: 2.45	50: 1.90

SNP



HF-Scaff pro PSA set Höhenfreak

Designed for scaffolding construction. Consisting of: safety harness, lanyard 2.0 m, back extension 0.60 m, stowage bag.

Info	H/L x B (m)	kg	Pack	Part No.	€/each
				06210	249.00



HF-Scaff pro Y-connector

Attaches to the lanyard's connecting ring with a screw snap hook Easy to retrofit to a Y-solution.

Info	H/L x B (m)	kg	Pack	Part No.	€/each
				06215	49.00



Kask helmet Plasma AQ

Comfortable work safety helmet:

- High-density, impact-resistant outer shell with drip edge
- 390 g light
- 10 air slits for particularly good ventilation
- Protected by a high-strength, aluminium mesh
- Adjustment by means of hand wheel with rubberised outer ring for enhanced grip
- Adapter clips on the outer shell for the attachment of accessories such as headlamps and various visors
- Internal padding can be washed at 30°
- Anti-allergic fabric with polygiene treatment prevents the growth of bacteria and bad odours
- Individually adjustable chinstrap with 4 anchor points
- Ring on chinstrap for attachment to belt or work gear
- Universally adjustable from 51 - 63 cm
- Corresponds to EN 397

Info	H/L x B (m)	kg	Pack	Part No.	€/each
white		0.56	1	07133	63.00 ②
yellow		0.56	1	07170	63.00 ②
orange		0.56	1	07171	63.00 ②
red		0.56	1	07172	63.00 ②
green		0.56	1	07173	63.00 ②
british green		0.56	1	07175	63.00 ②
light blue		0.56	1	07176	63.00 ②
blue		0.56	1	07177	63.00 ②
black		0.56	1	07178	63.00 ②

SNP



Many safety harness solutions on the market have been developed as a universal solution for very different occupational groups and applications. Scaffolding then somehow fitted into the concept - or not.

The result was often products that worked, but were hardly ever adapted to the needs of scaffolders.

This Höhenfreak-harness ticks differently - conceived and designed for scaffolding!

This harness combines many useful details for scaffolding construction and the cool design is only available from Scafom-rux.

DESIGNED FOR SCAFFOLDING

HF-140 SAFETY HARNESS

PRODUCT ON PAGE 22

SPECIFICATIONS

Traffic load	Up to 7.5 kN/m ²
Stair width	Variable from 1.00 m to 2.00 m
Stair height	16.60 cm
Base area	Variable (examples on the following pages)
System compatibility	Modular RINGSCAFF scaffolding, suitable for all scaffolding as a front-mounted stair tower
Approval	Gerüsttragkonstruktion aus RINGSCAFF, Zulassung Nr. Z-8.22-869



THE EMERGENCY STAIRWAY SOLUTION

The concept of the RUX universal stair tower 750 is based on a 12 to 16-leg scaffolding foundation and meets the higher requirements demanded in the regulation pertaining to public assembly areas.

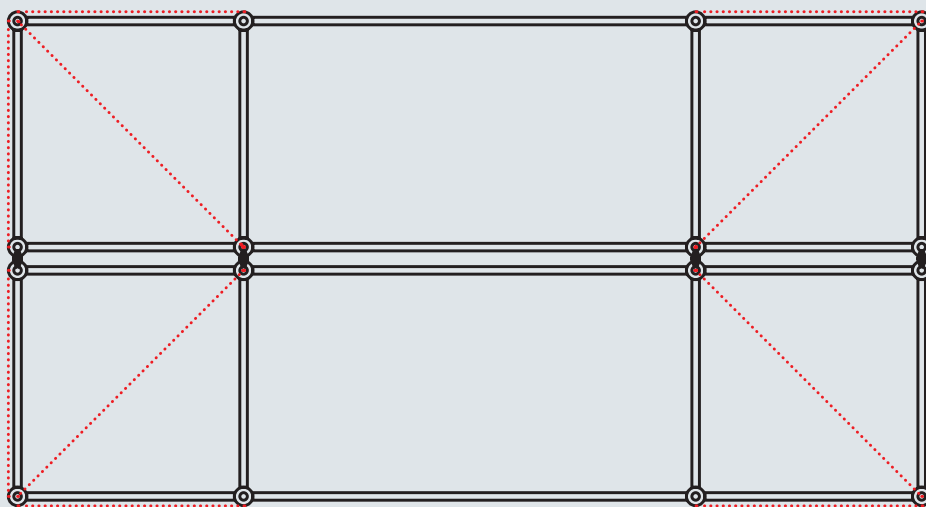

SIMPLE ASSEMBLY, FLEXIBLE WIDTH

The basic structure is built with standard components from the RINGSCAFF range.

Special elements such as the universal stair stringer and the handrails with filler struts complete the system. Standard scaffold decks with tube hook-up are inserted into the stair stringers as required.

STAIR TOWER WITH UNIVERSAL STAIR STRINGER

16-LEG FOR STAIR AND PLATFORM WIDTH OF 1.50 M

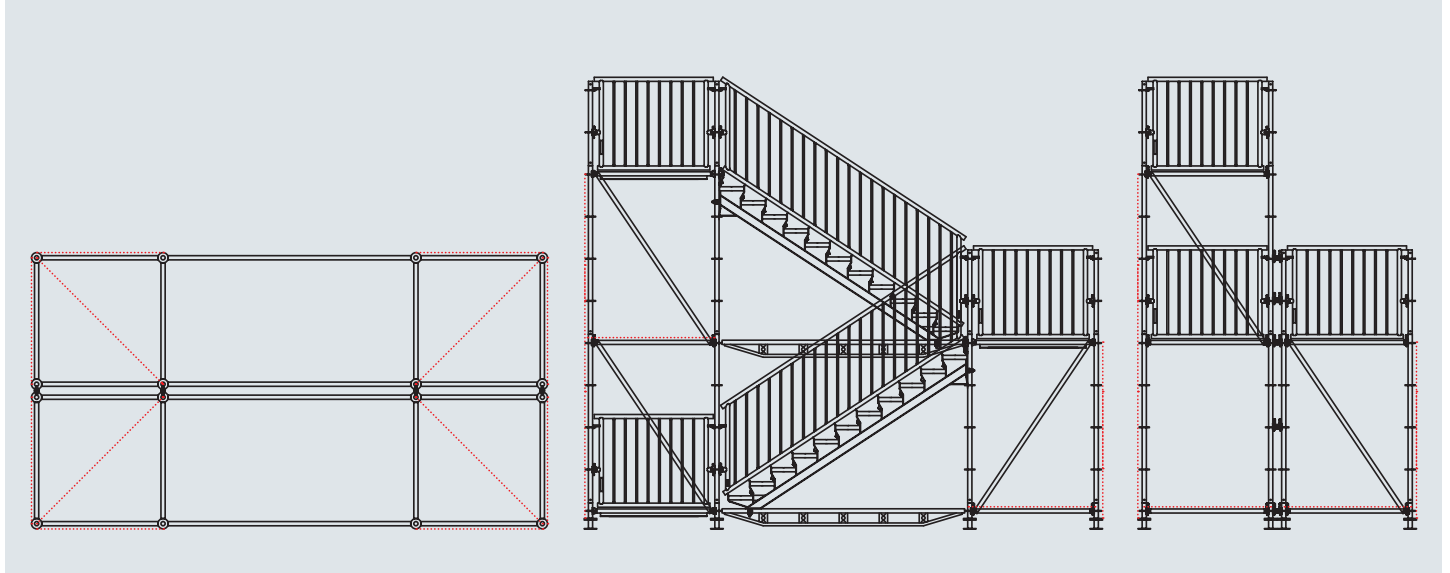

Material list for 16-leg stair tower with universal stair stringer: stair and platform width 1.50 m

Article Designation	Article No.	Exit height in m								
		4.00	6.00	8.00	10.00	12.00	14.00	16.00	18.00	20.00
Special parts for stair towers										
Base jack Ø 38 mm, H=0.60 m	08358	16	16	16	16	16	16	16	16	16
Standard lead-off adapter, L=0.26 m	E04RS0002	16	16	16	16	16	16	16	16	16
Standard without tube connector for suspended scaffolds, H=1.00 m	E04RS1033	16	16	16	16	16	16	16	16	16
Standard with tube connector, H=2.00 m	E04RS0071	16	32	48	64	80	96	112	128	144
Wedge head coupler, double	E04RS0617	14	22	30	38	46	54	62	70	78
Tubular ledger, L=1.50 m	E04RS0121	19	29	39	49	59	69	79	89	99
Tubular ledger reinforced, L=1.50 m	E04RS0266	8	12	16	20	24	28	32	36	40
Tubular ledger, L=3.00 m	E04RS0124	2	2	2	2	2	2	2	2	2
Double tubular ledger, L=3.00 m	E04RS0269	4	6	8	10	12	14	16	18	20
Horizontal ledger, L=1.50 m, W=1.50 m	E04RS0860	4	6	8	10	12	14	16	18	20
Diagonal, L=1.50 m, H=2.00 m	E04RS0131	9	14	19	24	29	34	39	44	49
Steel deck for tube hook-up 0.29 m, W=0.29 m, L=1.50 m	01694	33	49	65	81	97	113	129	145	161
Compensation deck 0.23 m, W=0.23 m, L=1.50 m	01700	10	16	22	28	34	40	46	52	58
First step 0.23 x 1.50 m	E04RS1707	5	7	9	11	13	15	17	19	21
Compensation deck 0.32 x 1.50 m	E04RS1708	1	2	3	4	5	6	7	8	9
Universal stair stringer 3.00 x 2.00 m, 11 Steps, AF 22 NEW	E04RS1694	4	6	8	10	12	14	16	18	20
Railing straight 1.50 m x H 1.10 m with wedge head and hook	E04RS1686	8	12	16	20	24	28	32	36	40
Railing slanted 3.00 x 2.00 m with wedge head and hook	E04RS1682	4	6	8	10	12	14	16	18	20
Step lift-off protection with wedge head for universal stair stringer	E04RS1695	4	6	8	10	12	14	16	18	20
Protective caps for railing ends	05633	24	36	48	60	72	84	96	108	120
Protective cap for standard rings, complete	05630	8	8	8	8	8	8	8	8	8
Protective caps for standard ends	01220	16	16	16	16	16	16	16	16	16
Underlay pad	05639	16	16	16	16	16	16	16	16	16

Note: Anchoring/ballast according to statics in individual cases. Structural analysis must be prepared separately!

EXAMPLES FOR MAXIMUM TOWER HEIGHTS

ALL STAIRS AND PLATFORMS CALCULATED WITH FULL TRAFFIC LOADS

Variant with 16 standards in 1 m to 20 m height possible

Tower with 16 standards and centre standard as double standard!

Anchoring on the long side at height intervals of ≤ 4.00 m, platform and stair width 1.00 m or 1.50 m.

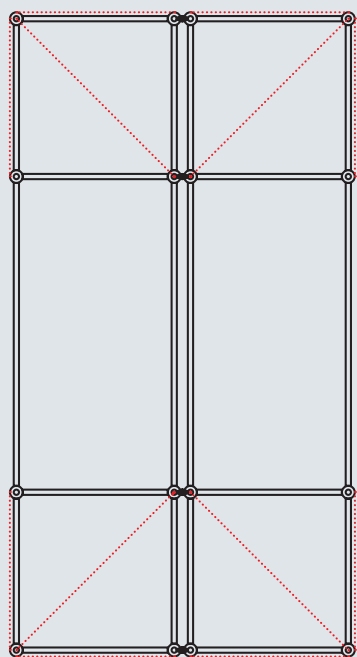
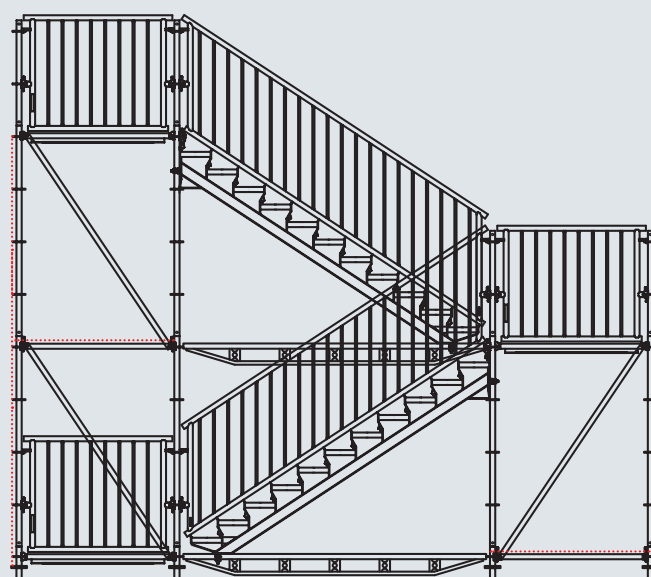
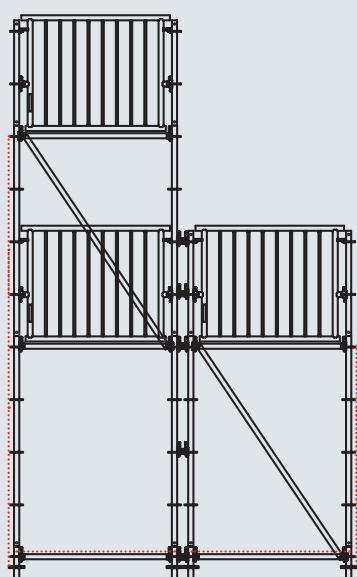

Permissible stair tower heights in relation to traffic load, platform and stair widths

Traffic load	Stair/Platform width	Tower height	Double standard
3.50 kN/m ²	1.00 m	18.00 m	from 0 – 8.00 m
3.50 kN/m ²	1.50 m	14.00 m	from 0 – 6.00 m
5.00 kN/m ²	1.00 m	16.00 m	from 0 – 8.00 m
5.00 kN/m ²	1.50 m	12.00 m	from 0 – 6.00 m
7.50 kN/m ²	1.00 m	14.00 m	from 0 – 6.00 m

Permissible stair tower heights in relation to traffic load, platform and stair widths

Traffic load	Stair/Platform width	Double standard
3.50 kN/m ²	1.00 m	10.00 m
3.50 kN/m ²	1.50 m	8.00 m
5.00 kN/m ²	1.00 m	8.00 m
5.00 kN/m ²	1.50 m	6.00 m
7.50 kN/m ²	1.00 m	8.00 m

Note: this information does not substitute statical analyses in individual cases! Full traffic load on all stairs and platforms!

GENERAL APPROVAL FOR THE SYSTEM APPROVAL Z-8.22-869 FOR RINGSCAFF

2 **Allgemeine bauaufsichtliche Zulassung/ Allgemeine Bauartgenehmigung**

1 **Deutsches Institut für Bautechnik** **DIBt**

Zulassungsstelle für Bauprodukte und Bauarten
Bautechnisches Prüfamt
Eine vom Bund und den Ländern
gemeinsam getragene Anstalt des öffentlichen Rechts
Mitglied der EOTA, der UEAtc und der WFTAO

Datum: 09.04.2021 Geschäftszeichen: I 37.1-1.8.22-69/20

3 Nummer:
Z-8.22-869

5 Antragsteller:
Scafom Holding b.v.
De Kempen 5
6021 PZ BUDEL
NIEDERLANDE

4 Geltungsdauer
vom: **10. April 2021**
bis: **10. April 2026**

6 Gegenstand dieses Bescheides:
Gerüstbauteile für das Modulsystem "RINGSCAFF"

7 Der oben genannte Regelungsgegenstand wird hiermit allgemein bauaufsichtlich zugelassen und genehmigt.
Dieser Bescheid umfasst 22 Seiten sowie Anlage A (Seiten 1 bis 4), Anlage B (Seiten 1 bis 63), Anlage C (Seiten 1 bis 4) und Anlage D (Seiten 1 bis 8).
Der Gegenstand ist erstmals am 5. März 2001 allgemein bauaufsichtlich zugelassen worden.



DIBt | Kolonnenstraße 30 B | D-10829 Berlin | Tel.: +49 30 78730-0 | Fax: +49 30 78730-320 | E-Mail: dibt@dibt.de | www.dibt.de

- 1** Deutsches Institut für Bautechnik (DIBt)

Registration Office for Building Products and Structural Designs

Structural Engineering Testing Agency
A public agency sponsored jointly by the federal and state governments
Member of EOTA, UEAtc and the WFTAO

Date: 9 April 2021
Reference: I 37.1-1.8.22-69/20
- 2** General building authority approval / General Type Approval
- 3** Approval number: Z-8.22-869
- 4** Validity
from: 10 April 2021
to: 10 April 2026
- 5** Applicant:
Scafom Holding b.v.
De Kempen 5
6021 PZ Budel
THE NETHERLANDS
- 6** Subject of approval:
Scaffolding components for the "RINGSCAFF" modular system
- 7** This above-mentioned subject of approval is herewith provided with a general type approval. This general type approval comprises twenty-two pages as well as an Appendix A (pages 1 to 4), Appendix B (pages 1 to 63), Appendix C (pages 1 to 4) and Appendix D (pages 1 to 8). The subject was first given a general type approval on 5 March 2001.

MIXING APPROVAL FUTURO-CONTUR APPROVAL Z-8.22-911 FOR RINGSCAFF

- 1 Deutsches Institut für Bautechnik (DIBt)
A public agency sponsored jointly by the federal and state governments

Authorisation and approval agency for construction products and types of construction
Date: 14 March 2022
Reference: I 37.1-1.8.22-15/19
- 2 General building authority approval / General type approval
- 3 Approval number: Z-8.22-911
- 4 Validity
from: 14 March 2022
to: 14 March 2027
- 5 Applicant:
Scafom Holding b.v.
De Kempen 5
6021 PZ Budel
THE NETHERLANDS
- 6 Subject of approval:
Scaffolding components for the "RINGSCAFF-V metric" modular system
- 7 The above-mentioned subject of regulation is hereby generally approved and authorised by the building authorities. This general type approval comprises twenty-three pages and an Appendix A (pages 1 to 3), Appendix B (pages 1 to 108), Appendix C (pages 1 to 4) as well as Appendix D (pages 1 to 8). This general building approval / general type approval replaces the general building approval no. Z-8.22-911 dated 11 January 2018. The subject was first given a general type approval on 14 December 2006 with the designation "Ring-scaff-V-f".

<p>2</p> <p>Allgemeine bauaufsichtliche Zulassung / Allgemeine Bauartgenehmigung</p>	<p>1</p> <p>Deutsches Institut für Bautechnik DIBt</p> <p>Eine vom Bund und den Ländern gemeinsam getragene Anstalt des öffentlichen Rechts</p> <p>Zulassungs- und Genehmigungsstelle für Bauprodukte und Bauarten</p> <p>Datum: 14.03.2022 Geschäftszeichen: I 37.1-1.8.22-15/19</p>
<p>3</p> <p>Nummer: Z-8.22-911</p> <p>5</p> <p>Antragsteller: Scafom Holding b.v. De Kempen 5 6021 PZ BUDEL NIEDERLANDE</p>	<p>4</p> <p>Geltungsdauer vom: 14. März 2022 bis: 14. März 2027</p>
<p>6</p> <p>Gegenstand dieses Bescheides: Gerüstbauteile für das Modulsystem "RINGSCAFF-V metrisch"</p>	
<p>7</p> <p>Der oben genannte Regelungsgegenstand wird hiermit allgemein bauaufsichtlich zugelassen und genehmigt. Dieser Bescheid umfasst 23 Seiten sowie Anlage A (Seiten 1 bis 3), Anlage B (Seiten 1 bis 108), Anlage C (Seiten 1 bis 4) und Anlage D (Seiten 1 bis 6). Diese allgemeine bauaufsichtliche Zulassung / allgemeine Bauartgenehmigung ersetzt die allgemeine bauaufsichtliche Zulassung Nr. Z-8.22-911 vom 11. Januar 2018. Der Gegenstand ist erstmals am 14. Dezember 2006 mit der Bezeichnung "Ringscaff-V-f" allgemein bauaufsichtlich zugelassen worden.</p>	
<p>DIBt</p> <p>DIBt Kolonnenstraße 30 B D-10829 Berlin Tel.: +49 30 78730-0 Fax: +49 30 78730-320 E-Mail: dibt@dibt.de www.dibt.de</p>	

MIXING APPROVAL ALLROUND

APPROVAL Z-8.22-901 FOR RINGSCAFF

2 **Allgemeine Bauartgenehmigung**

1 **Deutsches Institut für Bautechnik** **DIBt**

Zulassungsstelle für Bauprodukte und Bauarten
Bautechnisches Prüfamt
 Eine vom Bund und den Ländern
 gemeinsam getragene Anstalt des öffentlichen Rechts
 Mitglied der EOTA, der UEAtc und der WFTAO

Datum: 12.01.2021 Geschäftszeichen: I 37.1-1.8.22-67/20

3 **Nummer:**
Z-8.22-901

5 **Antragsteller:**
Scafom Holding b.v.
 De Kempen 5
 6021 PZ BUDEL
 NIEDERLANDE

6 **Gegenstand dieses Bescheides:**
Modulsystem "RINGSCAFF-V"

4 **Geltungsdauer**
 vom: **6. Januar 2021**
 bis: **6. Januar 2026**

7 Der oben genannte Regelungsgegenstand wird hiermit allgemein bauaufsichtlich genehmigt. Dieser Bescheid umfasst 19 Seiten sowie Anlage A (Seiten 1 und 2), Anlage B (Seiten 1 bis 101), Anlage C (Seiten 1 bis 4) und Anlage D (Seiten 1 bis 12). Der Gegenstand ist erstmals am 27. Juli 2005 allgemein bauaufsichtlich zugelassen worden.



DIBt | Kolonnenstraße 30 B | D-10829 Berlin | Tel.: +49 30 78730-0 | Fax: +49 30 78730-320 | E-Mail: dibt@dibt.de | www.dibt.de

- 1** Deutsches Institut für Bautechnik (DIBt)

Approval agency for construction products and types of construction

Structural Engineering Testing Agency

A public agency sponsored jointly by the federal and state governments

Member of EOTA, UEAtc and the WFTAO

Date: 12 January 2021
Reference: I 37.1-1.8.22-67/20
- 2** General Type Approval
- 3** Approval number: Z-8.22-901
- 4** Validity
from: 6 January 2021
to: 5 January 2026
- 5** Applicant:
Scafom Holding b.v.
De Kempen 5
6021 PZ Budel
THE NETHERLANDS
- 6** Subject of approval:
"RINGSCAFF-V" modular system
- 7** The above-mentioned subject of regulation is hereby generally approved by the building authorities. This general type approval comprises 19 pages as well as an Appendix A (pages 1 to 2), Appendix B (pages 1 to 101), Appendix C (pages 1 to 4) and Appendix D (pages 1 to 12). The subject was first given a general type approval on 27 July 2005.



SERVICE IS OUR HALLMARK, AND MARKING IS OUR SERVICE FOR YOU!

Ownership marking is becoming increasingly important – sometimes finance houses and insurers even demand this. But looking on the positive side: a professional external image and advertising impact should not be underestimated!

We offer various forms of material marking ranging from embossing and screen printing to solutions with stickers. Depending on the material, quantities involved and the motifs desired, there are a number of possible options which we would very much like to discuss with you in detail.



COATING

The classic solution for scaffolding! Just get some paint on it. That is exactly what we do with our rental material, too. Also available in fashionable RAL colours for your new material.



METAL EMBOSSING

We can supply individually embossed steel strip already affixed to the planks if desired. Individually embossed U-shaped caps are also available for SUPER planks.



OUR K++ STICKERS: YUCK!

Our K++ stickers are not quite as tasty as jelly babies, but they are just as colourful and a whole lot stickier – so at least it is two out of three points here! Moreover, they cannot be removed in a single piece, but only in shreds. And the best thing: they are available with your motif in small lot sizes!



EMBOSSING, COATING, STICKERS: **LAST!**

Anyone knowing a little about the whole thing, knows that it is not quite so easy to find marking solutions that last for a long time – and that is what is needed, of course. We work together with suppliers that are extremely proficient in the areas of embossing, marking, coating, labelling, adhesion etc.

Ask us to provide you with an individual quotation!



The **technical information** on our K++ stickers can be found in the download section of the scafom-rux.de homepage.



CALCULATOR, NEWS + MANUALS

You can access approval documents, technical details and manuals on our website with the APP. Our animations and current scafom-rux news are also available there.

So it is probably a good idea to surf over to the iOS or Android store and download the scaffold APP from there! Free of charge and without any in-app purchases.

QUICK ON-THE-SPOT ESTIMATE? APP-SOLUTELY NO PROBLEM!

Who doesn't know the situation: an impromptu enquiry and the customer is located along the way, so drive over quickly and have a look at the situation. Then the typical question: "Well, what sort of price can I expect?"

You will always have the answer right in your pocket: namely your smartphone with our scaffold APP. **This enables you to quickly calculate the parts needed for a façade or modular scaffolding as well as stair towers.** A few seconds later the customer has a general idea of the cost and you already have a rough parts list. You could even email us this list directly and make an order out of it. Not exactly unselfish, but still ingenious, isn't it?



NUMEROUS IMAGES, FEW WORDS: SCAFOM-RUX FILMS AND ANIMATIONS

Moving images providing information on the application, assembly and benefits of proven or new scafom-rux products? "Can't do any harm", we thought some years ago. In the meantime, the video library has grown to some 100 clips and the feedback from users proves that they are being readily used.

Our movies are available on **Youtube.de** and **Vimeo.com**. And when things get really tough, you can always use them to keep your interns quiet and happy for a while...

SORTED BY PRODUCT GROUPS, OPTIMISED FOR ALL DEVICES: WWW.SCAFOM-RUX.DE/EN/RECOURES/VIDEOS



E.g. SCAFFPLANK building site protection:

Protection against vandalism and noise as well as for passers-by during demolition work can be simply implemented through the use of standard planking that is just inserted into the system-independent SCAFFPLANK rails.

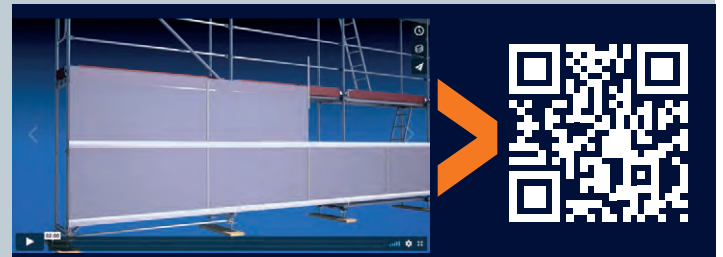

E.g. SCAFFGUARD scaffold cladding:

Economic, system-independent enclosures – and that with a minimal storage requirement. Building sites with scaffolding can be cladded very simply using SCAFFGUARD. System-independent!

MORE THAN 60 YEARS' EXPERIENCE

We have been involved in the manufacture of scaffolding for quite some time now. So it is not really surprising that our product ranges have been consistently adapted to meet market requirements and correspondingly enlarged.

But for all this, we have never lost sight of the fact that the user prefers specific components – namely those that are already in one's own stock. In other words, new products will always be confronted with the same question: "Is everything still compatible?".

Admittedly, we no longer have any parts in our ranges that are compatible with wooden ladder scaffolds... but otherwise we ensure economic product sustainability wherever it makes sense.

Our developments MULTI-ROOF and SCAFFPLANK are just two examples from many in this respect. The MULTI-ROOF solution can be accomplished using existing RINGSCAFF ledgers and in the case of SCAFFPLANK, existing decking can be used to protect the building site.

An intensive exchange with scaffold users additionally ensures that new developments really do make the daily work on the building sites easier: e.g. in terms of logistics, assembly and material optimisation and that they are, of course, needs-oriented. After all, you know best what you require in order to get the job done really well.

As an important part of the international scafom-rux group, we are more effective than ever: networked worldwide with specialists from development, manufacturing and application technology, we combine our profound expertise to go one step further in finding the best solution for your great projects. To put it in a nutshell:

SMART DETAILS, GREAT SOLUTIONS!



02 Façade scaffolding

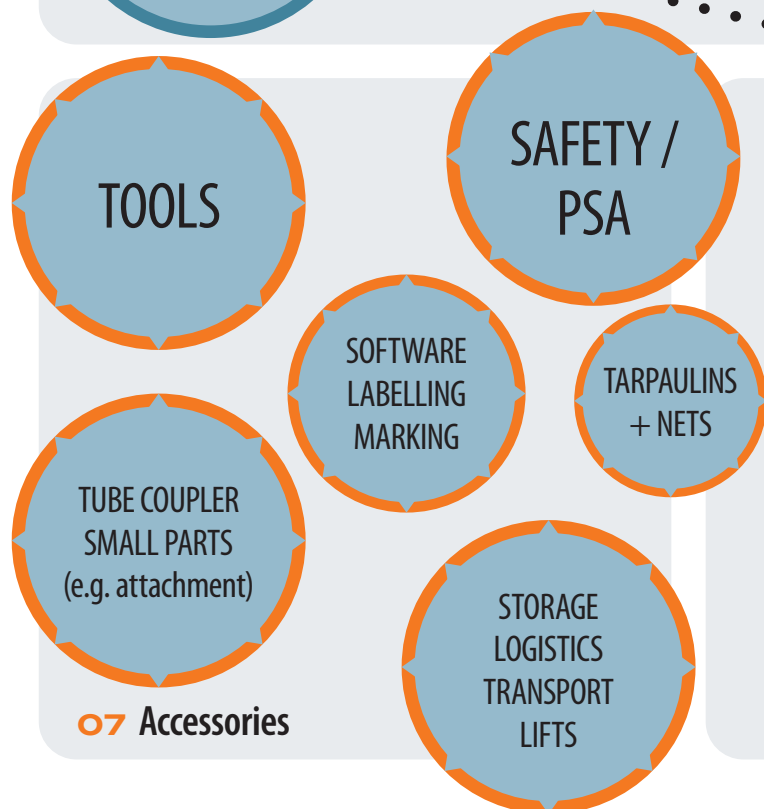
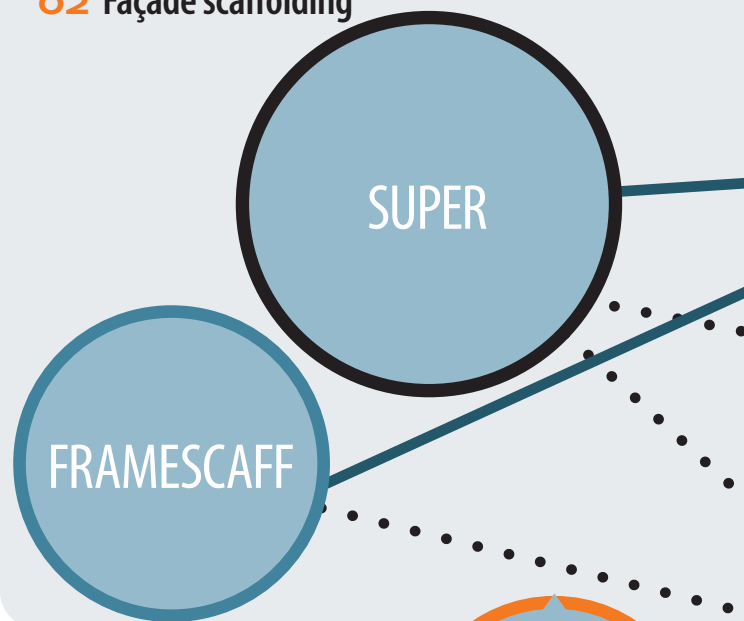

This overview shows you just how wide our product range is and how well one thing interconnects with the other.

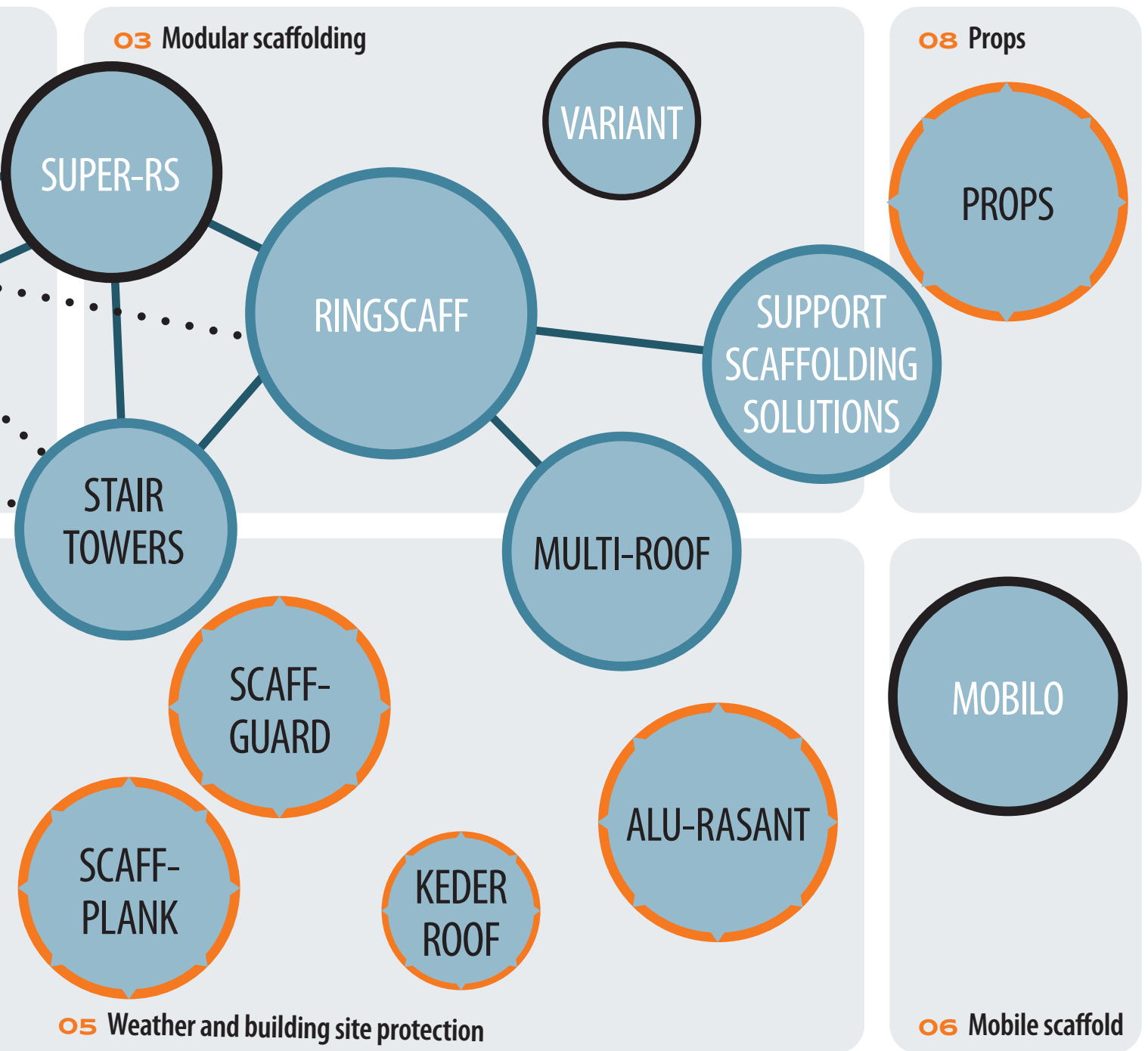

99 Category

SYSTEM

COMPATIBLE
SYSTEM WITH
MIXING
APPROVAL

SYSTEM-
INDEPENDENT
APPLICATION

SYSTEM-
ACCOMPANYING

CONNECTABLE

SCAFOM-RUX RENTAL - THE CLEVER ALTERNATIVE



RENTING INSTEAD OF BUYING - STAY LIQUID!

FAÇADE SCAFFOLDING, MODULAR SCAFFOLDING,
ACCESSORIES, STAIR TOWERS, ROOFING, LIFTS

In times like these, flexibility is absolutely essential if you wish to stay competitive. Renting scaffold material is a real alternative to buying both in terms of material availability as well as when peak order demands have to be met.

Our rental specialists will gladly inform you about when and for whom rental is worthwhile.

**YOU HAVE THE PROJECT,
WE SUPPLY THE MISSING
PUZZLE PIECES**

- **Flexibility both financially and in terms of time**
- **Planning and calculation reliability**
- **Fixed, low monthly payments instead of high investments**
- **Original material in manufacturer quality**
- **Safeguarding of order peaks**
- **Closing investment gaps**



THE SCAFOM-RUX RENTAL-TEAM AVAILABLE FOR YOU

Phone +49 2331 47 09-333
Fax +49 2331 47 09-222
E-Mail rental@scafom-rux.de



RENTAL AND COLLECTION DEPOTS IN GERMANY

Central Depot Hagen

Neue Str. 7
58135 Hagen
Telephone +49 (0) 2331 4709-333

Rental Depot Leipzig

An der Bahn 11
04319 Leipzig-Engelsdorf
Telephone +49 (0)341 251 38 05

Rental Depot Hamburg

Kulemannstieg 5
22457 Hamburg
Telephone +49 (0)40 54 80 57 48

Rental Depot Berlin

Zobtener Str. 73
10317 Berlin-Lichtenberg
Telephone +49 (0)30 51 58 88-22

Rental Depot Hannover

Entenfangweg 9
30419 Hannover
T +49 (0)511 450 100 00

Rental Depot Munich

Krautgartenstr. 36
85241 Hebertshausen
Telephone +49 (0)175 50 76 708



SMART DETAILS
RINGSCAFF | UNIVERSAL STAIR TOWER

MODULAR SCAFFOLDING
FAÇADE SCAFFOLDING
WEATHER PROTECTION
BUILDING SITE PROTECTION
MOBILE SCAFFOLDS
PROPS
ACCESSORIES
IDEAS

STRONGER.
TOGETHER.



APP



Vimeo | YouTube



FACEBOOK



LINKEDIN



SCAFOM-RUX.DE

Scafom-rux GmbH

Neue Str. 7 · 58135 Hagen · Germany
T +49 2331 4709-0 · info@scafom-rux.de

 **scafom-rux**